

Label applicators

The ALstep industrial labeling heads are particularly compact and economical. Thanks to its modular design, the machine body can be arranged in different configurations to suit any packaging line. The side-access paper reel and web path allow for easy label changes.

The control electronics are separated from the machine body and housed in a separate box, featuring a compact, hygienic design. It can be orientated in different ways to always ensure an ergonomic access. The fan less control box and next generation components deliver unprecedented levels of reliability and allow for 110 and 230 V power supply.

Product features

The ALstep is one of the best-selling labeling heads on the market, due to its incomparable price/performance ratio. It comes in two versions, S or M, which differ with regard to the label maximum width, 100 mm and 200 mm respectively. Thanks to a powerful microprocessor-controlled stepper motor, it can reach a speed of 30 m/min (20 m/min in the M version) and can hold label reels up to 300 mm diameter for longer run times. It is fitted with a display featuring 4 function keys positioned on the control box, through which labelling parameters - including advanced functions - can be entered.

The ALstep E is the entry-level model of the ALstep series: the letter E (Economical) refers to its low cost and compactness. The special design of the machine body - fitted with a 230-mm diameter roll unwind - and the 100 mm paper width make it the smallest labelling head on the market. This model is particularly suitable for promotional labelling, including packaging lines with limited availability of space. It is equipped with a microprocessor-controlled stepper motor which achieves a dispensing speed of 18 m/min. The labeling parameters (speed, pre-dispensing, and label delay) can be set through the display with three function keys, positioned on the control box. The automatic recovery of missing labels on the web is standard on all ALstep models.

Standard features

- Adjustment of label dispensing in m/min;
- Pre-dispensing adjustment in mm;
- Labeling delay adjustment in mm;
- Automatic recovery for missing labels;
- Progressive counter;
- End-of-roll alarm and web break alarm with warning on display;
- Output connection to other systems.

Available features

- Printers for variable data;
- Label sensor for transparent material;
- Pneumatic air-blow applicators;
- Checking device for near end of label reel, with multi-colour alarm beacon;
- Multi-page label kit;
- Speed matching via encoder;
- Kit for ultra-compact configuration (with reduced unwinder unit).

Configuration Examples

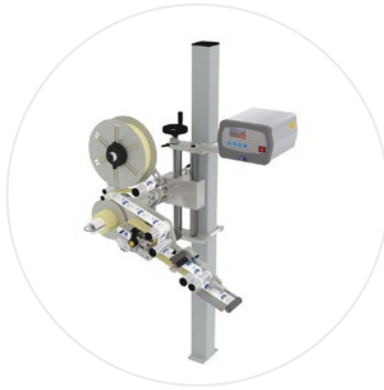

Technical Specifications

	ALSTEP E	ALSTEP S/M
Label Width	Max 100 mm	Max 100 mm (S), 200 mm (M)
Max Speed	15 m/min	30 m/min (S), 20 m/min (M)
Control	Display and function buttons	
Label Position	Manual	Electronic
End-of-roll and web break alarm	Standard	
Missing Labels Recovery	Not available	Standard
Pieces Counter	Not available	Standard
Transparent Label Sensor	Optional	
Coder / TT Printer	Not available	Optional
Near End of Reel Check	Not available	Optional
Pneumatic Application	Not available	Optional
Encoder	Not available	Optional
Unwind Unit Diameter	300 mm	
Power Supply	110-230 V, 50-60 Hz, 200 W	

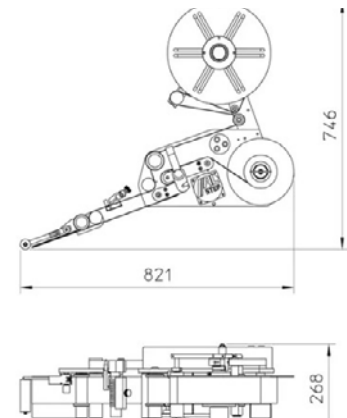

For more information, contact Tigerpak Industrial Supplies, 6810 Kitimat Rd, Unit 1, Mississauga, Ontario, L5N 5M2, Canada.

Telephone:
 Ontario (289) 328-0651, (877) 538-8078
 Quebec (514) 587-2607, (855) 296-4372

E-mail: Sales@Tigerpak.ca Info@Tigerpak.ca
 Website: www.tigerpak.ca

